

STRICKLAND BRIDGE

Fayetteville, NC

3 Spaces Available: 1,200 SF
1,500 SF
2,400 SF

1 Outparcel: 6.87 ac
Subdividable

Current tenants:

A Touch of Class
China #1
Food Lion
Jester's Pub
Subway
Tobacco Shop
Town Beauty Supply

Located at Fisher and Strickland
Roads

Population Info

Within 1 mile: 6,317 people
Within 3 miles: 41,668 people
Within 5 miles: 119,770 people

Traffic Counts

7,000 ADT on Fisher Road



Retail Space for Lease

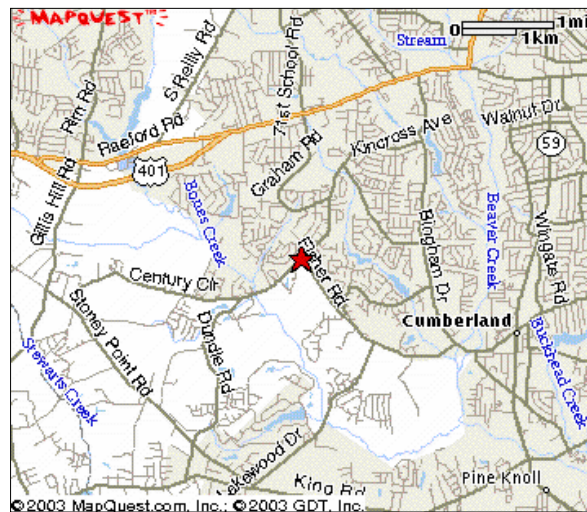

Karen Senchak

P.O. Box 33279 Raleigh, NC 27636
919.821.7890 ~ 919.821.2070 fx
ksenchak@lundygroup.com

www.lundygroup.com



Member of
International Council
of Shopping Centers

*The information in this flyer is accurate to the best of Lundy's knowledge
and is subject to change without notice.*

STRICKLAND BRIDGE

Site Plan

SITE DATA:

SITE SIZE:	6.12 AC.
SHOPPING CENTER:	6.87 AC.
ADDITIONAL PROPERTY:	
PARKING	
TOTAL SPACES	267 SP
SPACES PER 1,000	5.32 SP

BUILDING SIZE:

1: FOOD LION	202'W x 176'D	33,800 S.F.
2: SHOP	15'W x 60'D	900 S.F.
3: SHOP	25'W x 60'D	1,500 S.F.
4: SHOP	20'W x 60'D	1,200 S.F.
5: SHOP	21,23'W x 65'D	1,800 S.F.
6: SHOP	40'W x 60'D	2,400 S.F.
7: SHOP	20'W x 60'D	1,388 S.F.
8: SHOP	20'W x 60'D	1,200 S.F.
9: SHOP	20'W x 30'D	600 S.F.
10,11,12&13: SHOP	110'W x 60'D	5,360 S.F.
TOTAL:		50,148 S.F.

NOTE: WIDTH OF SHOPS GIVEN AT FRONT. DIMENSIONS AT REAR OF SHOPS MAY VARY. SEE PLAN.

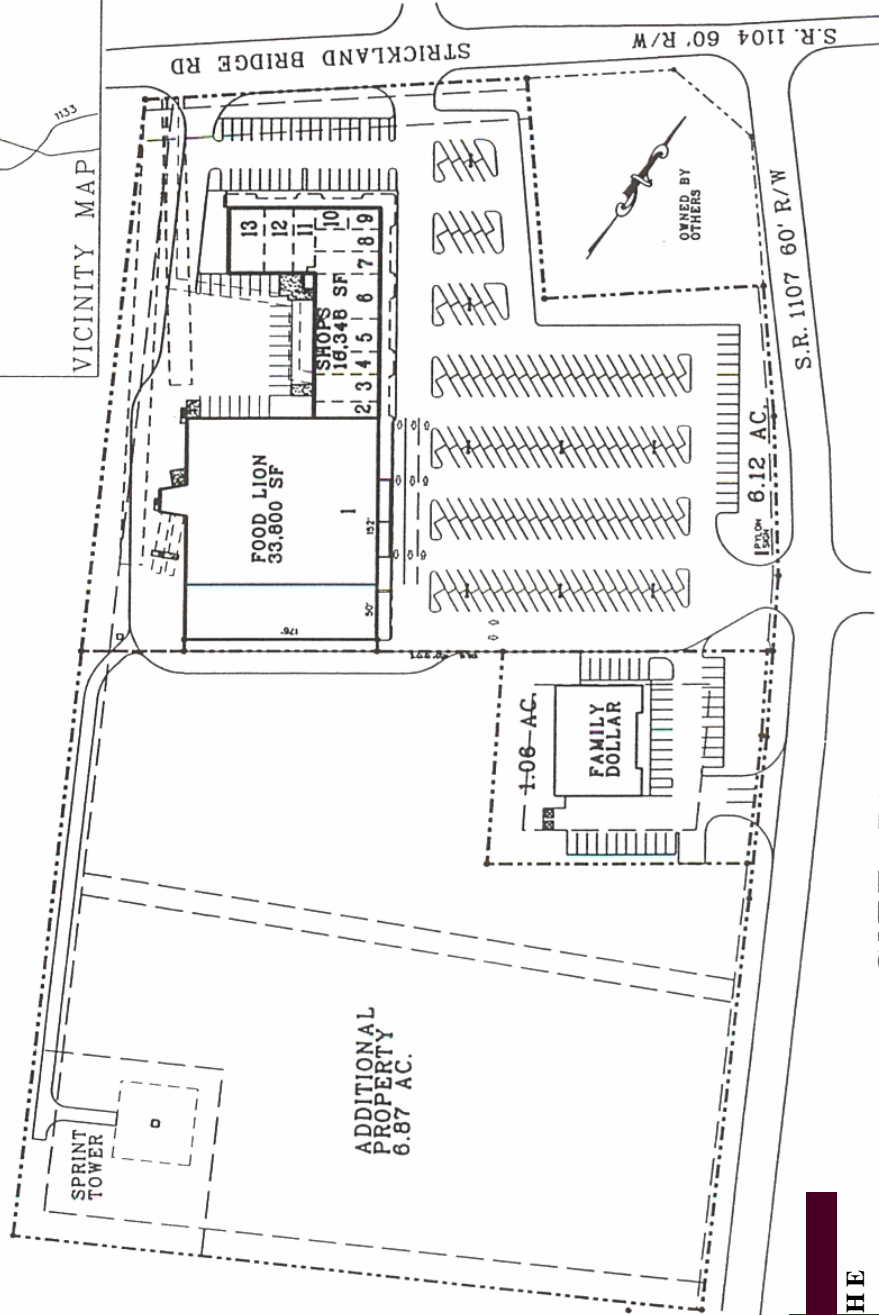
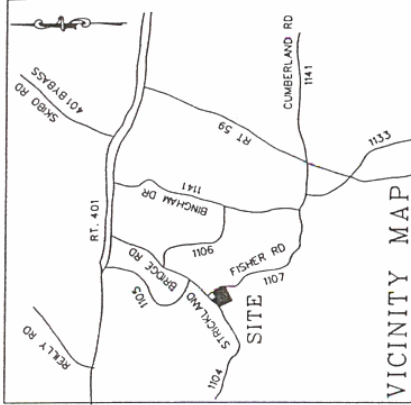

STRICKLAND BRIDGE SHOPPING CTR
CUMBERLAND COUNTY
NORTH CAROLINA

DRAWN: 6/19/96
REV: 3/1/97
11/13/98
12/02/98
9/15/02

dm! Development-Management, Incorporated
P.O. Box 35349, Charlotte, NC 28235-5349
1701 East 3rd Street, Charlotte, NC 28204
Phone: (704) 343-0056 Fax (704) 343-0059
dmEdmt-nc.com



919.821.7890
www.lundygroup.com

SITE PLAN
NOT TO SCALE